

DESIGN FOR LIFE

Jeremy Myerson, Helen Hamlyn Professor of Design Royal College of Art.

Iain McKinnon, Co-founder, Director of Operations and Inclusive Design at the Global Disability Innovation Hub.

Tama Duffy Day, Principal Gensler Global Senior Living Practice Gensler.

John Mathers, former Design Council CEO and current Chair of the British Design Fund and campaign for Healthy Ageing by Design.

Peter Maxwell, Director of Design for the London Legacy Development Corporation.

 @agileageing @isostandards  agileageingalliance #agileageing #bettertogether

AAA ISO AGEING SOCIETIES LEADERS FORUM | 28TH JANUARY 2021



In association with



Teeter-Totter Wall at US-Mexico border

Design Museum's Design of the Year 2020

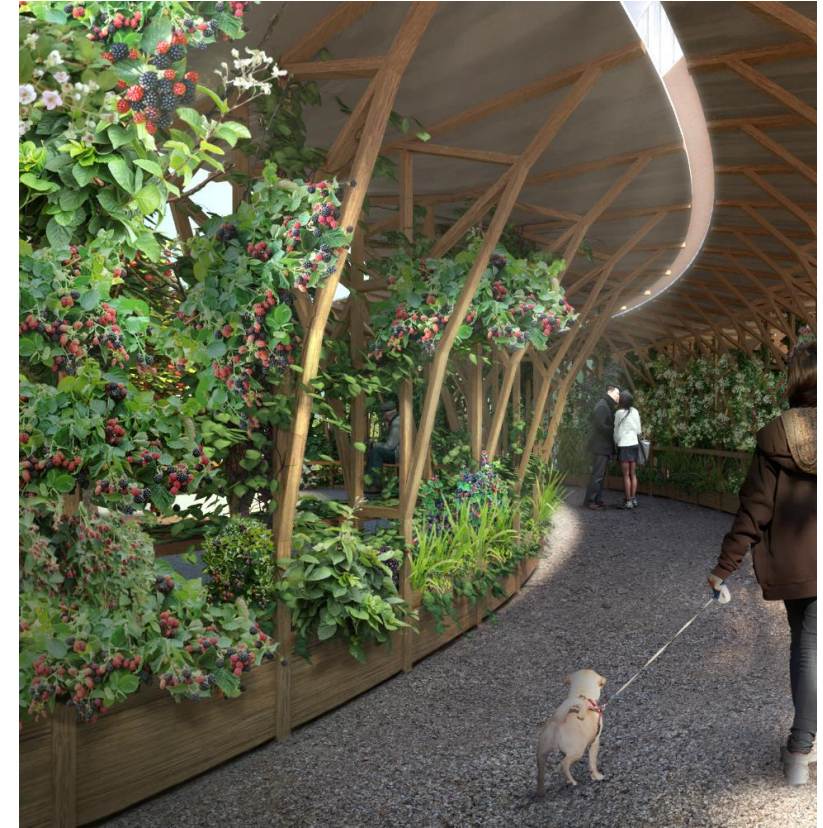

Public, Private and
Privileged

The 15 Minute City



SUPERBLOCKS MODEL

Current Model

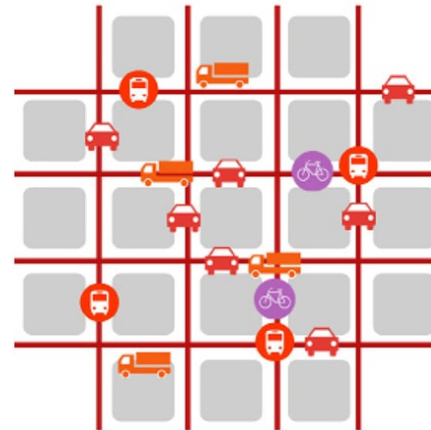

Superblocks Model



- PUBLIC TRANSPORT NETWORK
- BICYCLES MAIN NETWORK (BIKE LANE)
- BICYCLES SIGNPOSTS (REVERSE DIRECTION)
- FREE PASSAGE OF BICYCLES

- PRIVATE VEHICLE PASSING
- RESIDENTS VEHICLES
- URBAN SERVICES AND EMERGENCY
- DUM CARRIERS
- DUM PROXIMITY AREA
- ACCESS CONTROL
- BASIC TRAFFIC NETWORK
- SINGLE PLATFORM (PEDESTRIANS PRIORITY)

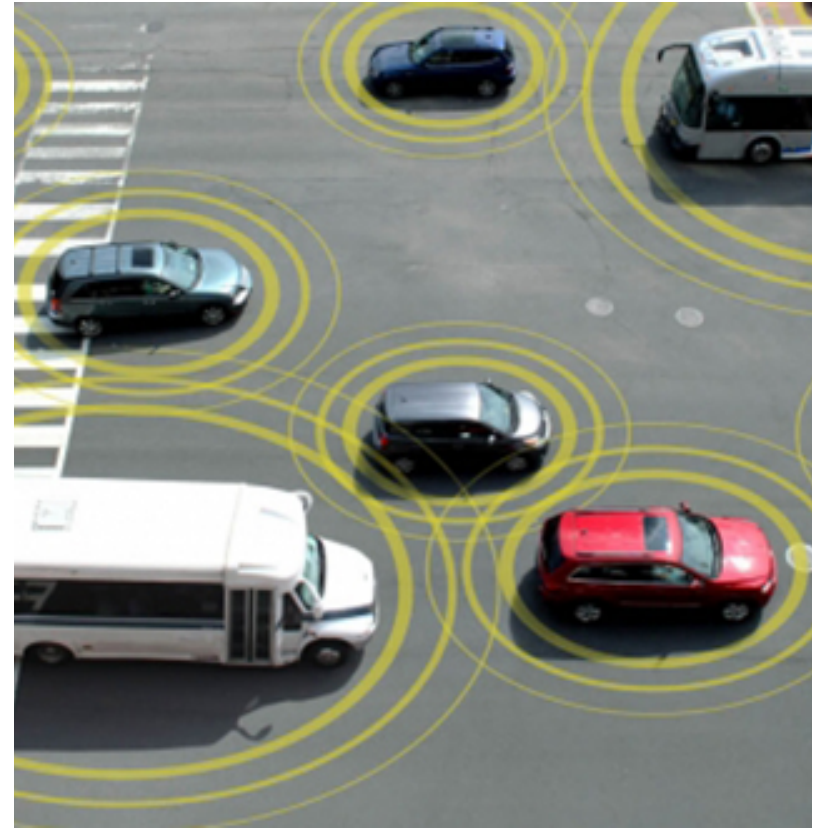

Driven by data

ABOUT GENSLER

1965

FOUNDED

50

OFFICES

100%

EMPLOYEE-OWNED

6000+

EMPLOYEES

1000+

UNIVERSITIES REPRESENTED

80+

LANGUAGES SPOKEN

1000+

DESIGN AWARDS
WON GLOBALLY

Washington, D.C.

VOTED ONE OF THE MOST

INNOVATIVE

COMPANIES OF 2019
BY FAST COMPANY

#1

ARCHITECTURE
FIRM OVERALL
BY ARCHITECTURAL
RECORD & ENGINEERING
NEWS RECORD

VOTED ONE OF THE

**BEST PLACES
TO WORK** 2020

BY GLASSDOOR

EQUITY BY DESIGN PODCAST

REDEFINING "SENIOR LIVING"

- DESIGNING MULTIGENERATIONAL COMMUNITIES
- BUILDING AGE-FRIENDLY CITIES



STEPHANIE FIRESTONE



ESTHER GREENHOUSE



DR. BILL THOMAS



RETHINKING LONGEVITY IN AN AGE-INCLUSIVE WORLD



1. RECONNECT WITH NATURE
2. REDEFINE PUBLIC AND PRIVATE SPACES.
3. EMBRACE TECHNOLOGY.
4. ENCOURAGE A DIVERSITY OF SPACES TO PROMOTE WELLNESS.
5. ELIMINATE AGEISM.



OUR FOCUS IN 2021

*FOR THE FIRST TIME IN HISTORY, PERSONS AGED 65 OR ABOVE
OUTNUMBER CHILDREN UNDER FIVE YEARS OF AGE GLOBALLY.*



**AGE-INCLUSIVE DESIGN
AND STANDARDS**



**ADOPT TECHNOLOGY
TO ASSIST LIVING
INDEPENDENTLY**



**PROMOTE WELL-BEING
FOR ALL**

THANK YOU!



TAMA DUFFY DAY, FIIDA, LEED-AP
GLOBAL SENIOR LIVING PRACTICE LEADER, PRINCIPAL
TAMA_DUFFYDAY@GENSLER.COM

MOBIE

Ministry of Building
Innovation and Education



About MOBIE

“

Home is the most important piece of architecture in our lives. It crafts the way we live, and how we grow as families and communities. A well-designed home can enhance the way we live and promote our well-being.

”

George Clarke MOBIE Founder

“I started MOBIE to create a generational shift in home building”



MOBIE
Ministry of Building
Innovation and Education



HOME

+

EDUCATION

+

ENGAGEMENT

+

INNOVATION



[illegible]



INNOVATION + EDUCATION

ARE VITAL TO THE CREATION
OF BETTER QUALITY HOMES

Design Age Accelerator

Design Age
Accelerator

#LivingLongerBetter

Accelerating innovation, scale-ups and building connectivity in Healthy Ageing



UK Research
and Innovation

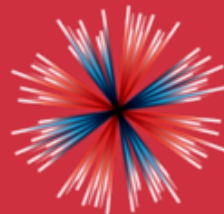

INDUSTRIAL
STRATEGY

What is it?

At its core the DAA is about accelerating the pace of innovation in the Healthy Ageing market, encouraging and supporting early stage entrepreneurs, encouraging scale-up and building connectivity

To do this successfully the DAA will need to create demand and encourage adoption

A key outcome will be the access and connectivity that will come from the work at the core and the community that is created within the Healthy Ageing 'ecosystem'



#LivingLongerBetter

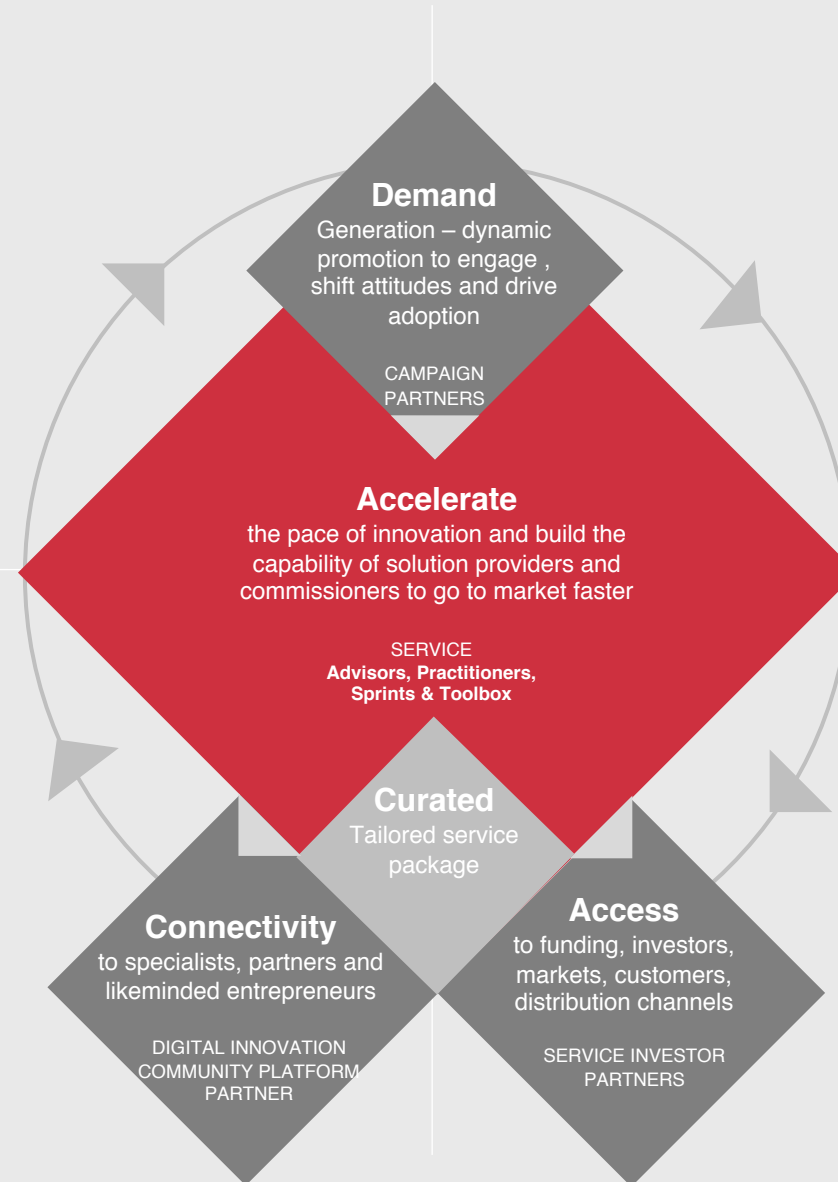



**Design Age
Accelerator**

#LivingLongerBetter

“The healthy ageing market is ready for a disruptive, independent proposition that pulls different resources together.”

Ian Spero, Founder Agile Ageing Alliance and publisher of Neighbourhoods of the Future

The Challenge

**Design Age
Accelerator**

#LivingLongerBetter

How can this Multi-generational Neighbourhood Programme attract young user-centred design thinkers and entrepreneurs to both accelerate the innovation opportunity and be involved in the development of new standards?



NOON LEGACY
DEVELOPMENT
CORPORATION

PETER MAXWELL
DIRECTOR OF DESIGN

AAA ISO AGEING SOCIETIES LEADERS FORUM

QUEEN ELIZABETH
OLYMPIC PARK,
LONDON



STRATFORD

CITY OF
LONDON

HOUSES OF
PARLIAMENT

CANARY
WHARF

OLYMPIC GAMES (2012)



POST-GAMES LEGACY

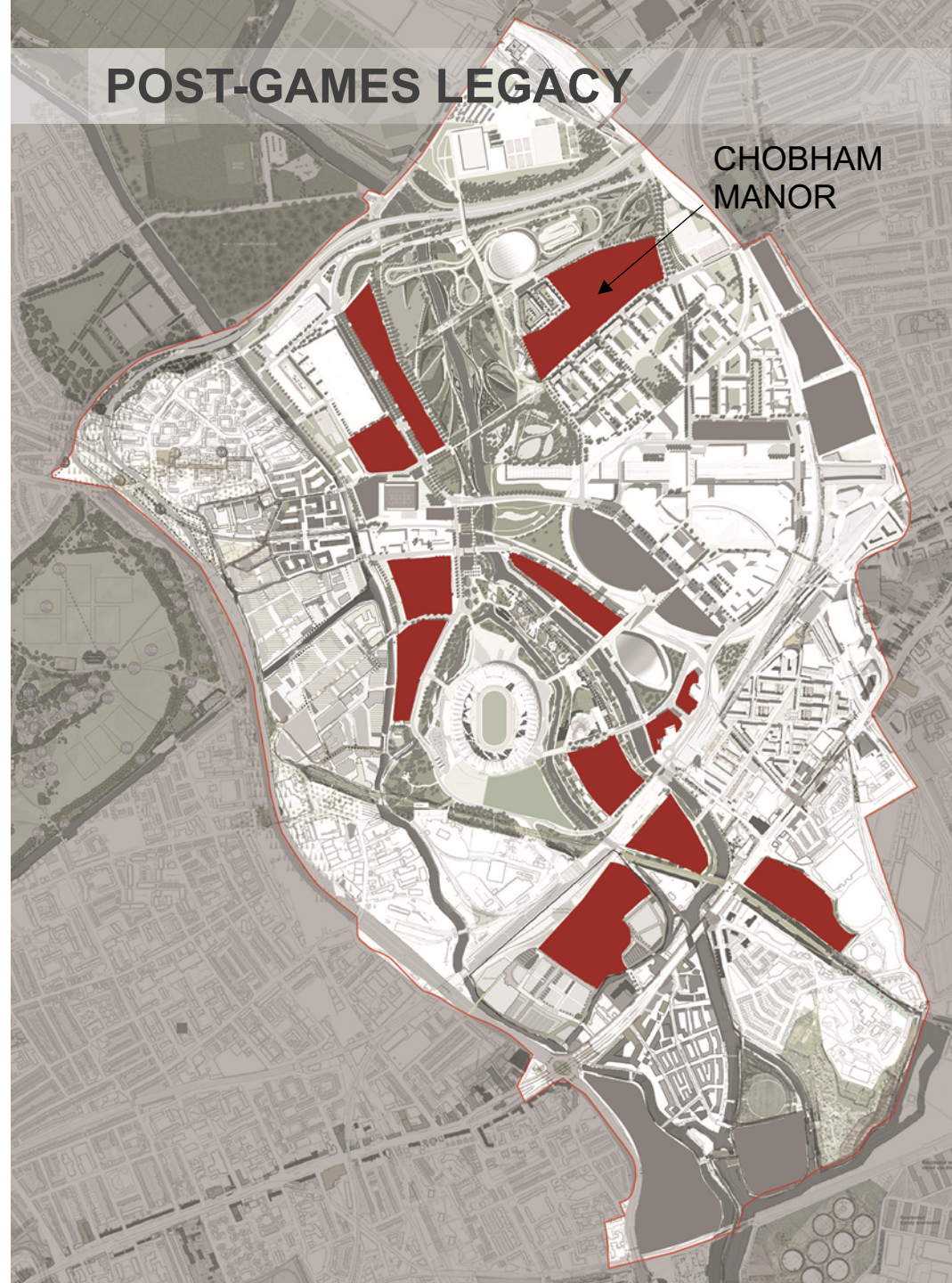

**PARK RE-OPENED
AFTER 12 MONTHS
560 ACRES OF
PARKLAND
6.5km CLEANED UP
WATERWAYS
4300 NEW TREES
4 OLYMPIC VENUES
RETAINED**

**PLANNING
GRANTED FOR:-
5 NEW MIXED USE
NEIGHBOURHOODS
5500 NEW HOMES –
FAMILY HOUSING /
AFFORDABLE
HOUSING
JOBS
3 SCHOOLS
NEW PUBLIC REALM**

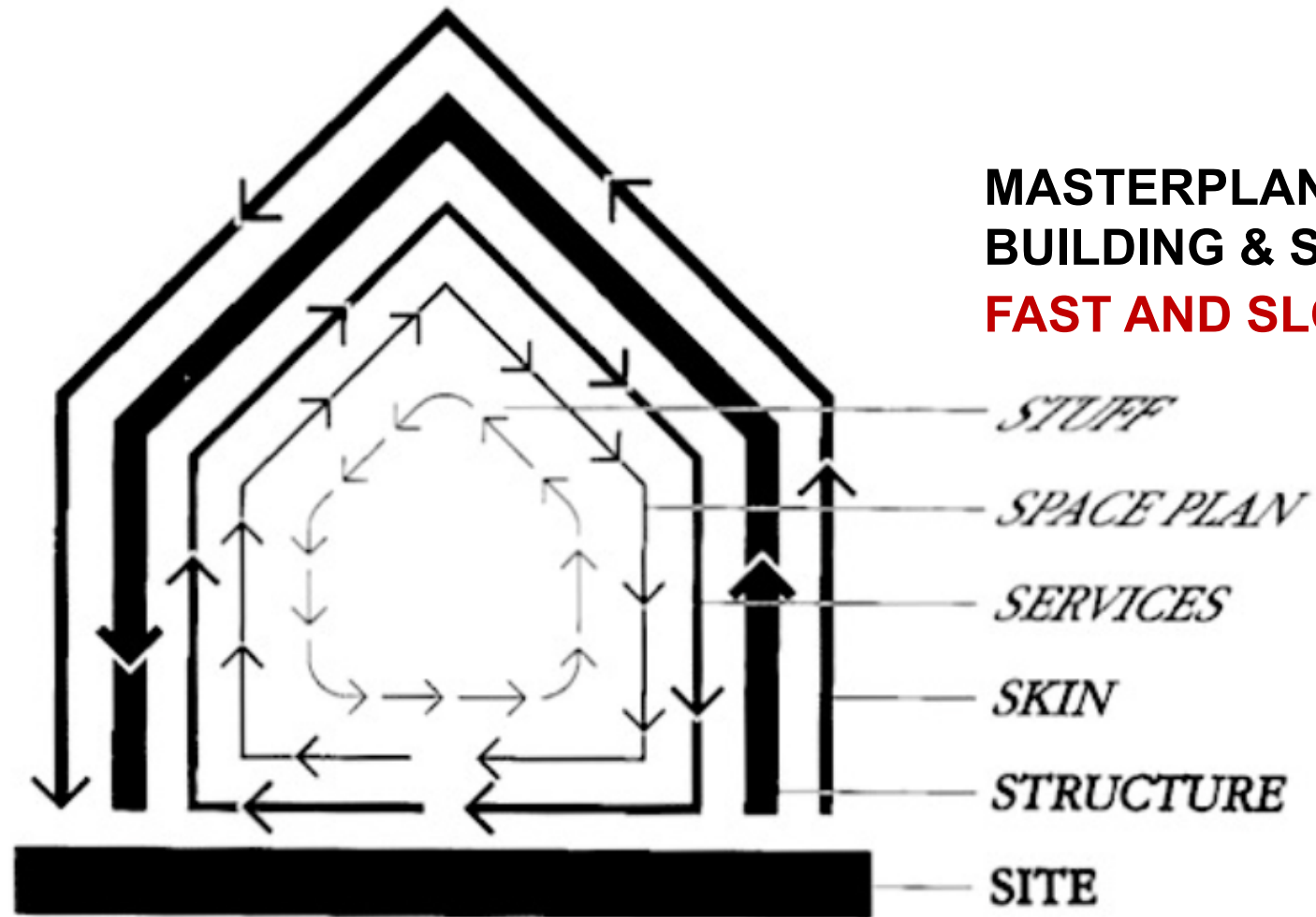

MASTERPLANNING
BUILDING & SPACES
FAST AND SLOW LAYERS

MASTERPLANNING & ITS DEFINITION THROUGH A NEW STANDARD?



ACCESS TO NATURAL ENVIRONMENT

ORIENTATION
AND LAYOUT

TRANSPORT
CONNECTIONS

LOCATION OF
AMENITY &
COMMUNITY
SPACE

WALKABLE NEIGHBOURHOODS,
PLOTS & BLOCK SIZE

VARIETY OF HOUSING TYPES

STREET, LANDSCAPE & PUBLIC REALM
STRUCTURE

BUILDINGS
AND SPACES
DEFINITION?

ENOUGH SPACE?

ADAPTABILITY

USE

STANDARDS – DESIGN, INCLUSION, SUSTAINABILITY



**UNDERSTANDING HOW
NEIGHBOURHOODS,
BUILDINGS AND SPACES
WORK**

BOTH FOR THE
COMMUNITY AND
TECHNICALLY

HOW TO CAPTURE
CONTINUAL LEARNING AS
PART OF ANY STANDARD



Post occupancy evaluation

Multi-generational living